

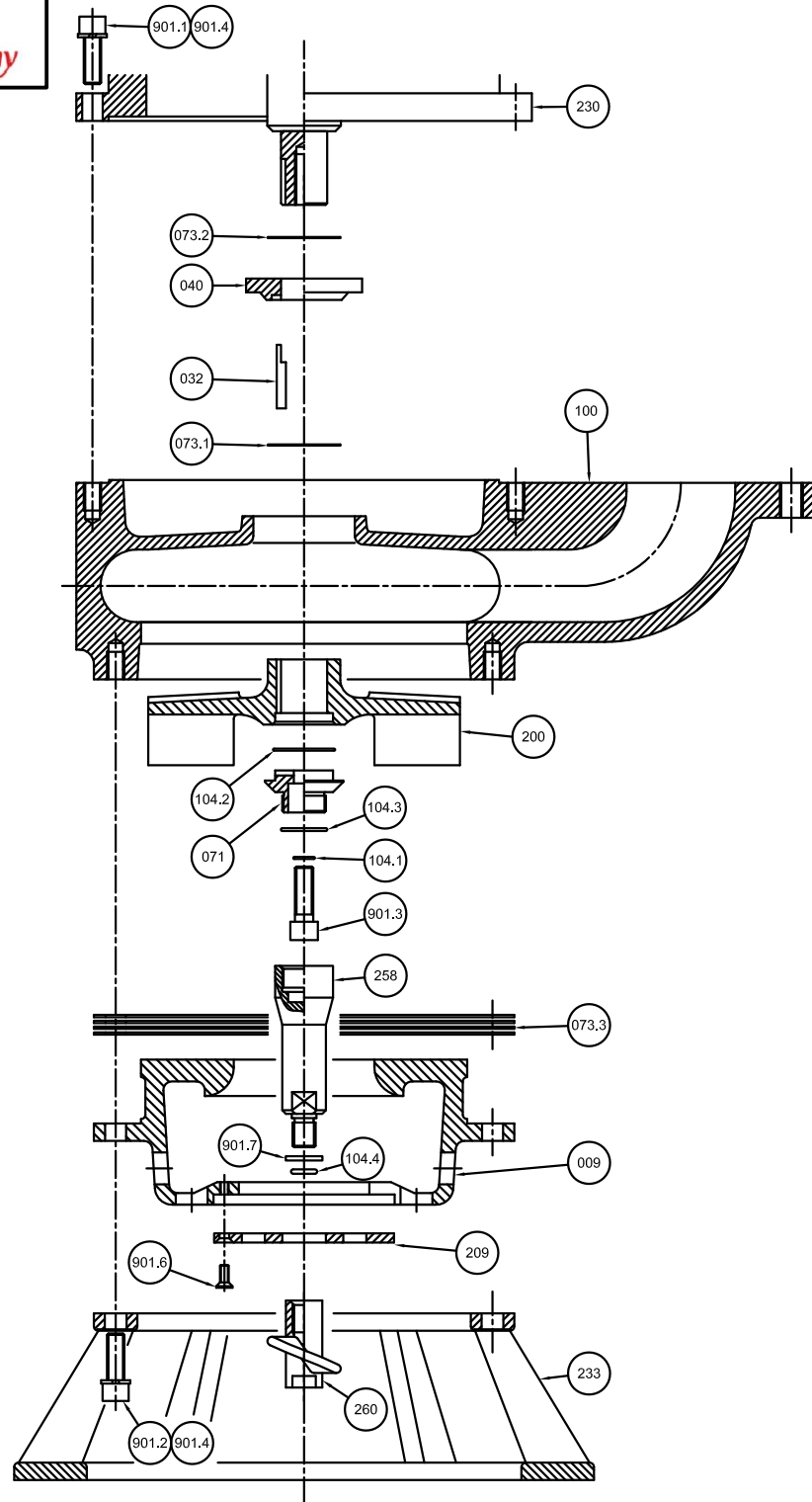

VULCAN PUMPS - HDS 50L-A (HIGH CHROME WET END / LOW PRESSURE HYDRAULIC / 2 INCH DISCHARGE / AGITATOR)

ITEM	ITEM	ITEM	ITEM	PART NUMBER	QTY.	DESCRIPTION	EXT. DESC.1	MODEL1	MODEL 2	WT. (KG)	WT. (lbs)	MTL.	DWG. #
707				707.2000.03552		KIT, WET END - COMPLETE	215mm IMP	HDS 50L	A	67.69	148.83	HIGH CHROME	
	701			701.2000.03431		KIT, WET END - BASIC	215mm IMP	HDS 50L		66.15	145.43	HIGH CHROME	
		100		100.1228.03001	1	CASING	VOLUTE	HDS 50L				A532 CL III TP. A	D1000
		200		200.1228.03031	1	IMPELLER	RH, 4V, 215mm VTD	HDS 50L				A532 CL III TP. A	C1030
		009		009.1228.03083	1	COVER	SUCTION	HDS 50L				A532 CL III TP. A	D1060
		040		040.2229.03211	1	DEFLECTOR	IMPELLER	FRAME 180TY / 210 TYS				ASTM A276 TYPE 316	B1107
		233		233.1051.03063	1	STAND	PUMP	HDS 50L				ASTM A536 Gr. 80-55-06	C1390
		032		032.2228.03263	1	KEY	DRIVE	FRAME 180TY / 210 TYS				304SS	B1118
		902		902.2000.03336	1	KIT, FASTENER						A4/70	
		901.1		901.2334.03279	8	FASTENER	SCREW	HEX SOCKT.HD.CAP	DIN 912 / M12 X 35			A4/70	
		901.2		901.2334.03332	6	FASTENER	SCREW	HEX SOCKT.HD.CAP	DIN 912 / M12 X 45			A4/70	
		901.3		901.2255.03295	1	FASTENER	SCREW	HEX SOCKT.HD.CAP	ANSI B18.3 / 1/2"UNC X 1.50"			17-4 H 1150	
		901.4		901.2334.03291	14	FASTENER	WASHER	LOCK	DIN 127B / M12			A4/70	
		903.1		903.2000.03342	1	KIT, GASKET		FRAME 180TY / 210 TYS					
		073.1		073.5108.03345	1	GASKET	IMPELLER	FRAME 180TY / 210 TYS				Durlon 8500	B1121
		073.2		073.5108.03346	1	GASKET	DEFLECTOR	FRAME 180TY / 210 TYS				Durlon 8500	B1124
		903.2		903.2000.03351	1	KIT, GASKET		HDS 50L					
		073.3		073.5108.03358	4	GASKET	SUCTION	HDS 50L				Durlon 8500	B1127
		905		905.2000.03121	1	KIT, AGITATOR		HDS 50L	A	0.85	1.88		
		260		260.1228.03127	1	AGITATOR	ROTATING	HDS 50L	A			A532 CL III TP. A	B1086
		209		209.2338.03155	1	SCREEN	SUCTION	HDS 50L				QT400	B1096
		901.6		901.2334.03298	3	FASTENER	SCREW	HEX SOCKT, CSK. HD. FLAT	DIN 7991 / M6 X 12			A4/70	
		906		906.2000.03312	1	KIT, SHAFT EXTENSION		HDS 50L	A	0.69	1.52		
		071		071.2259.03185	1	ADAPTER	SHAFT	FRAME 180TY / 210 TYS	A			ASTM A564 Gr.630 (17-4 PH)	B1104
		258		258.2259.03322	1	EXTENSION	SHAFT	HDS 50L	A			ASTM A564 Gr.630 (17-4 PH)	B1152
		904.1		904.2000.03385	1	KIT, O-RING						BUNA	
		104.1		104.5600.03391	1	O-RING	12 x 1.5					BUNA	
		104.2		104.5600.03393	1	O-RING	40 x 1.5					BUNA	
		904.2		904.2000.03388	1	KIT, O-RING						BUNA	
		104.3		104.5600.03396	1	O-RING	28 x2					BUNA	
		104.4		104.5600.03397	1	O-RING	12 x 3					BUNA	
		901.7		901.2334.03306	1	FASTENER	WASHER	CUSTOM	M16			A4/70	

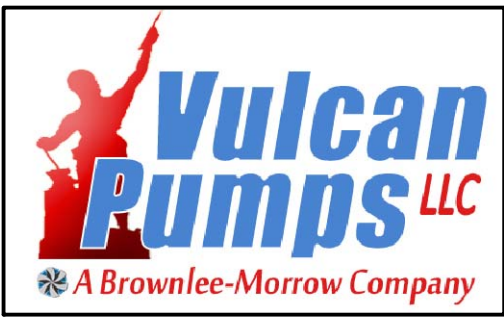

WET END PARTS - BOM	
HDS 50L-A (AGITATOR)	
DRAWING NBR.: A1175	REV.: 1
EFFECTIVE DATE : 5 FEB 2013	