

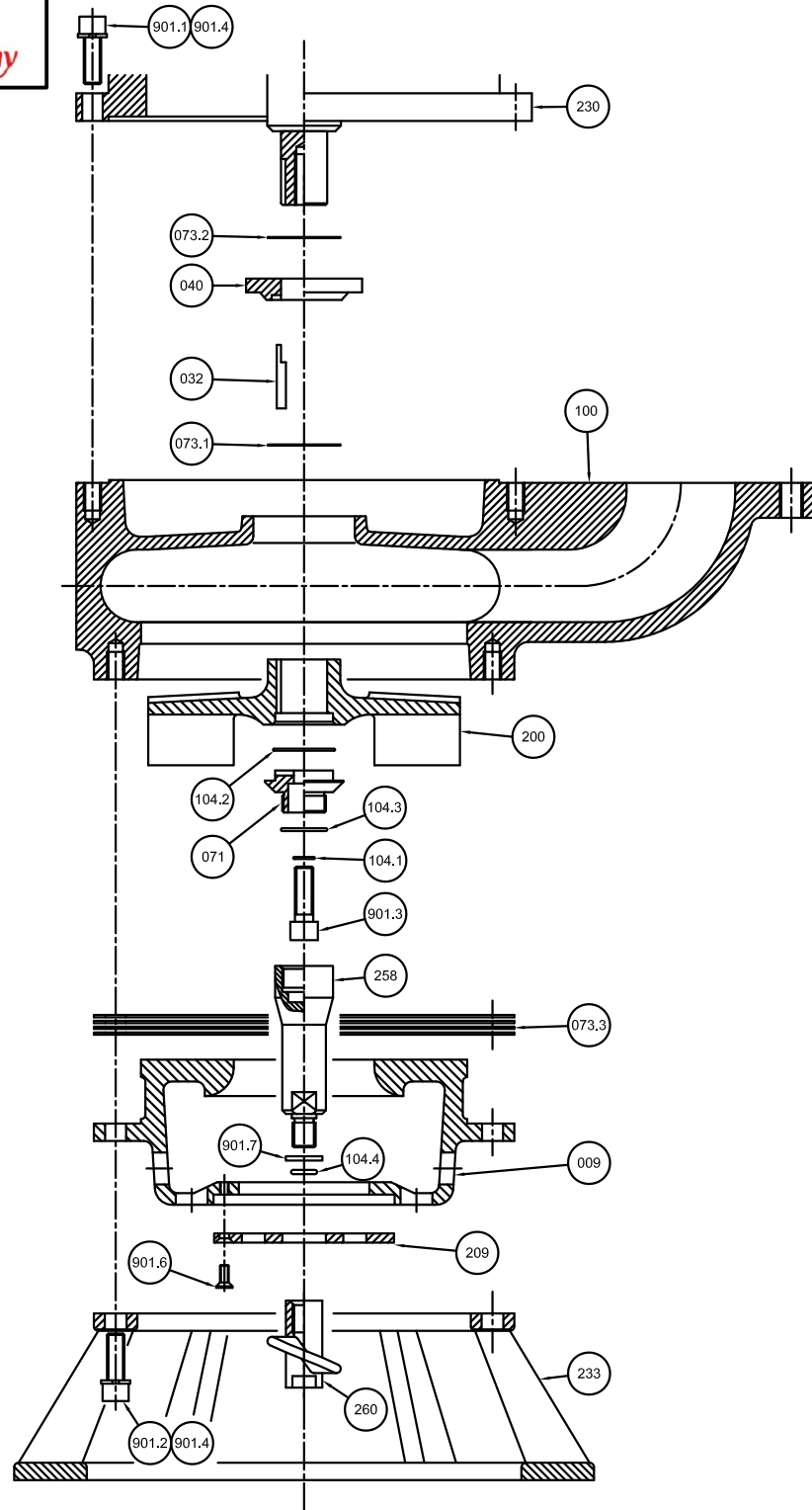

**VULCAN PUMPS - HDS 75L-A (HIGH CHROME WET END / LOW PRESSURE HYDRAULIC / 3 INCH DISCHARGE / AGITATOR)**

ITEM	ITEM	ITEM	ITEM	PART NUMBER	QTY.	DESCRIPTION	EXT. DESC.1	MODEL1	MODEL 2	WT. (KG)	WT. (lbs)	MTL.	DWG. #
707				<b>707.2000.03568</b>		<b>KIT, WET END - COMPLETE</b>	<b>215mm IMP</b>	<b>HDS 75L</b>	<b>A</b>	<b>77.5</b>	<b>171.275</b>	<b>HIGH CHROME</b>	
	701			<b>701.2000.03443</b>		<b>KIT, WET END - BASIC</b>	<b>215mm IMP</b>	<b>HDS 75L</b>		<b>75.96</b>	<b>167.1</b>	<b>HIGH CHROME</b>	
		100		100.1228.03003	1	CASING	VOLUTE	HDS 75L				A532 CL III TP. A	D1003
		200		200.1228.03033	1	IMPELLER	RH, 4V, 215mm VTD	HDS 75L				A532 CL III TP. A	C1033
		009		009.1228.03085	1	COVER	SUCTION	HDS 75L				A532 CL III TP. A	D1062
		040		040.2229.03211	1	DEFLECTOR	IMPELLER	FRAME 180TY / 210 TYS				ASTM A276 TYPE 316	B1107
		233		233.1051.03063	1	STAND	PUMP	HDS 75L				ASTM A536 Gr. 80-55-06	C1390
		032		032.2228.03263	1	KEY	DRIVE	FRAME 180TY / 210 TYS				304SS	B1118
		<b>902</b>		<b>902.2000.03336</b>	1	<b>KIT, FASTENER</b>						<b>A4/70</b>	
		901.1		901.2334.03279	8	FASTENER	SCREW	HEX SOCKT.HD.CAP	DIN 912 / M12 X 35			A4/70	
		901.2		901.2334.03332	6	FASTENER	SCREW	HEX SOCKT.HD.CAP	DIN 912 / M12 X 45			A4/70	
		901.3		901.2255.03295	1	FASTENER	SCREW	HEX SOCKT.HD.CAP	ANSI B18.3 / 1/2"UNC X 1.50"			17-4 H 1150	
		901.4		901.2334.03291	14	FASTENER	WASHER	LOCK	DIN 127B / M12			A4/70	
		<b>903.1</b>		<b>903.2000.03342</b>	1	<b>KIT, GASKET</b>		FRAME 180TY / 210 TYS					
		073.1		073.5108.03345	1	GASKET	IMPELLER	FRAME 180TY / 210 TYS				Durlon 8500	B1121
		073.2		073.5108.03346	1	GASKET	DEFLECTOR	FRAME 180TY / 210 TYS				Durlon 8500	B1124
		<b>903.2</b>		<b>903.2000.03351</b>	1	<b>KIT, GASKET</b>		HDS 75L					
		073.3		073.5108.03358	4	GASKET	SUCTION	HDS 75L				Durlon 8500	B1127
		<b>905</b>		<b>905.2000.03121</b>	1	<b>KIT, AGITATOR</b>		<b>HDS 75L</b>	<b>A</b>	<b>0.85</b>	<b>1.88</b>		
		260		260.1228.03127	1	AGITATOR	ROTATING	HDS 75L	A			A532 CL III TP. A	B1086
		209		209.2338.03155	1	SCREEN	SUCTION	HDS 75L				QT400	B1096
		901.6		901.2334.03298	3	FASTENER	SCREW	HEX SOCKT, CSK. HD. FLAT	DIN 7991 / M6 X 12			A4/70	
		<b>906</b>		<b>906.2000.03314</b>	1	<b>KIT, SHAFT EXTENSION</b>		<b>HDS 75L</b>	<b>A</b>	<b>0.69</b>	<b>1.52</b>		
		071		071.2259.03185	1	ADAPTER	SHAFT	FRAME 180TY / 210 TYS	A			ASTM A564 Gr.630 (17-4 PH)	B1104
		258		258.2259.03324	1	EXTENSION	SHAFT	HDS 75L	A			ASTM A564 Gr.630 (17-4 PH)	B1153
		<b>904.1</b>		<b>904.2000.03385</b>	1	<b>KIT, O-RING</b>						<b>BUNA</b>	
		104.1		104.5600.03391	1	O-RING	12 x 1.5					BUNA	
		104.2		104.5600.03393	1	O-RING	40 x 1.5					BUNA	
		<b>904.2</b>		<b>904.2000.03388</b>	1	<b>KIT, O-RING</b>						<b>BUNA</b>	
		104.3		104.5600.03396	1	O-RING	28 x2					BUNA	
		104.4		104.5600.03397	1	O-RING	12 x 3					BUNA	
		901.7		901.2334.03306	1	FASTENER	WASHER	CUSTOM	M16			A4/70	



WET END PARTS - BOM	
HDS 75L-A (AGITATOR)	
DRAWING NBR.: A1181	REV.: 1
EFFECTIVE DATE : 5 FEB 2013	