

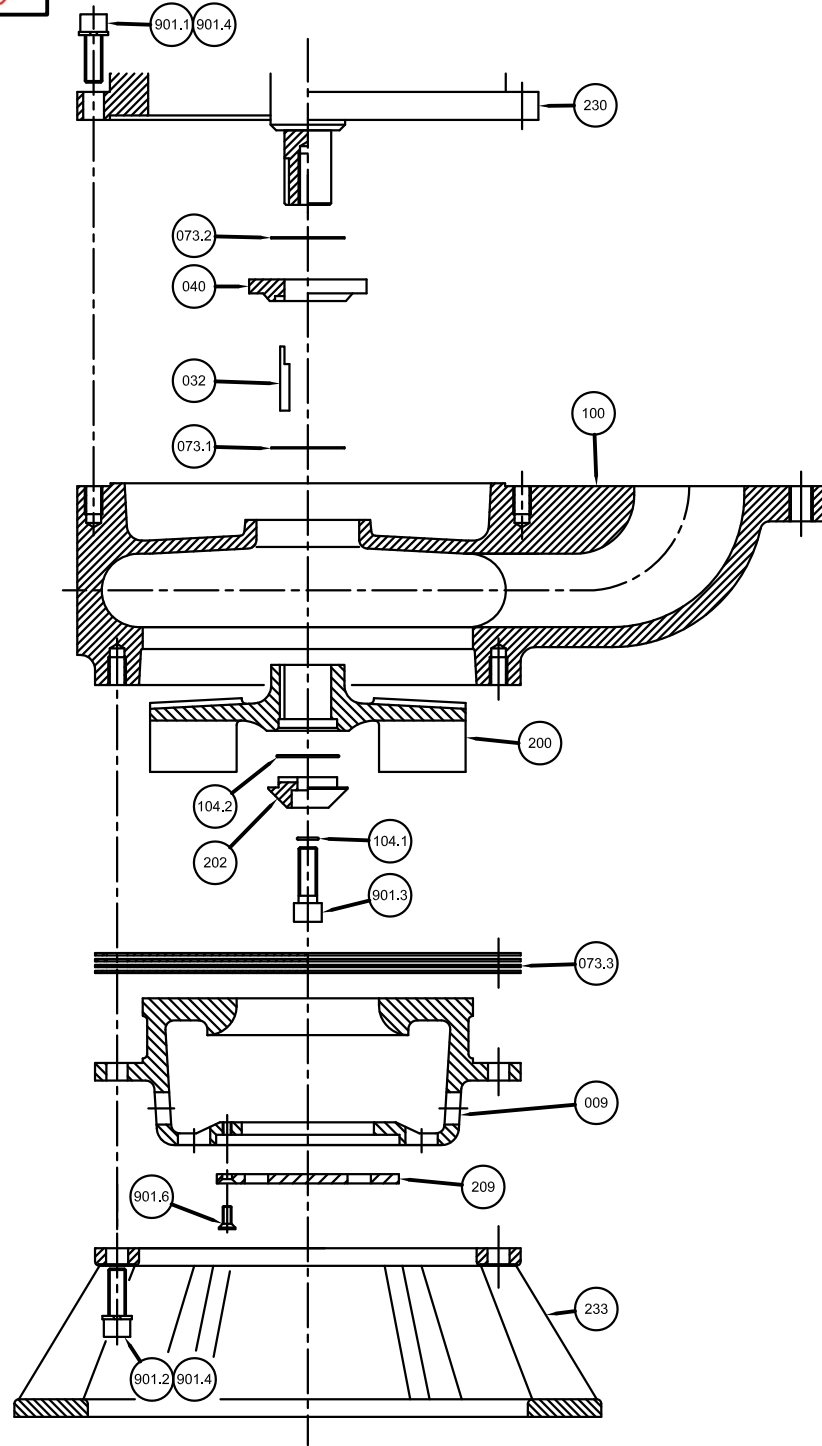

VULCAN PUMPS - HDS 100L-O (HIGH CHROME WET END / LOW PRESSURE HYDRAULIC / 4 INCH DISCHARGE / OPEN SUCTION)

| ITEM | ITEM | ITEM | ITEM | PART NUMBER | QTY. | DESCRIPTION | EXT. DESC.1 | MODEL1 | MODEL 2 | WT. (KG) | WT. (lbs) | MTL. | DWG. # |
|------|------|-------|------|----------------|------|-------------------------|-------------------|--------------------------|------------------------------|----------|-----------|----------------------------|--------|
| 707 | | | | 707.2000.03583 | | KIT, WET END - COMPLETE | 230mm IMP | HDS 100L | O | 90.68 | 199.5 | HIGH CHROME | |
| | 701 | | | 701.2000.03455 | 1 | KIT, WET END - BASIC | 230mm IMP | HDS 100L | | 89.95 | 197.9 | HIGH CHROME | |
| | | 100 | | 100.1228.03005 | 1 | CASING | VOLUTE | HDS 100L | | | | A532 CL III TP. A | D1006 |
| | | 200 | | 200.1228.03035 | 1 | IMPELLER | RH, 4V, 230mm VTD | HDS 100L | | | | A532 CL III TP. A | C1036 |
| | | 009 | | 009.1228.03087 | 1 | COVER | SUCTION | HDS 100L | | | | A532 CL III TP. A | D1064 |
| | | 040 | | 040.2229.03211 | 1 | DEFLECTOR | IMPELLER | FRAME 180TY / 210 TYS | | | | ASTM A276 TYPE 316 | B1107 |
| | | 233 | | 233.1051.03065 | 1 | STAND | PUMP | HDS 100L | | | | ASTM A536 Gr. 80-55-06 | C1392 |
| | | 032 | | 032.2228.03263 | 1 | KEY | DRIVE | FRAME 180TY / 210 TYS | | | | 304SS | B1118 |
| | | 902 | | 902.2000.03336 | 1 | KIT, FASTENER | | | | | | A4/70 | |
| | | 901.1 | | 901.2334.03279 | 8 | FASTENER | SCREW | HEX SOCKT.HD.CAP | DIN 912 / M12 X 35 | | | A4/70 | |
| | | 901.2 | | 901.2334.03332 | 6 | FASTENER | SCREW | HEX SOCKT.HD.CAP | DIN 912 / M12 X 45 | | | A4/70 | |
| | | 901.3 | | 901.2255.03295 | 1 | FASTENER | SCREW | HEX SOCKT.HD.CAP | ANSI B18.3 / 1/2"UNC X 1.50" | | | 17-4 H 1150 | |
| | | 901.4 | | 901.2334.03291 | 14 | FASTENER | WASHER | LOCK | DIN 127B / M12 | | | A4/70 | |
| | | 903.1 | | 903.2000.03342 | 1 | KIT, GASKET | | FRAME 180TY / 210 TYS | | | | | |
| | | 073.1 | | 073.5108.03345 | 1 | GASKET | IMPELLER | FRAME 180TY / 210 TYS | | | | Durlon 8500 | B1121 |
| | | 073.2 | | 073.5108.03346 | 1 | GASKET | DEFLECTOR | FRAME 180TY / 210 TYS | | | | Durlon 8500 | B1124 |
| | | 903.2 | | 903.2000.03352 | 1 | KIT, GASKET | | HDS 100L | | | | | |
| | | 073.3 | | 073.5108.03359 | 4 | GASKET | SUCTION | HDS 100L | | | | Durlon 8500 | B1128 |
| | | | | | | | | | | | | | |
| | | 909 | | 909.2000.03150 | 1 | KIT, INTAKE SCREEN | | HDS 100L | O | 0.5 | 1.1 | | |
| | | 209 | | 209.2338.03154 | 1 | SCREEN | SUCTION | HDS 100L | | | | QT400 | B1095 |
| | | 901.6 | | 901.2334.03298 | 3 | FASTENER | SCREW | HEX SOCKT, CSK. HD. FLAT | DIN 7991 / M6 X 12 | | | A4/70 | |
| | | | | | | | | | | | | | |
| | | 907 | | 907.2000.03191 | 1 | KIT, IMPELLER CAP | | HDS 100L | O | 0.23 | 0.5 | | |
| | | 202 | | 202.2259.03197 | 1 | CAP | SHAFT | FRAME 180TY / 210 TYS | O | | | ASTM A564 Gr.630 (17-4 PH) | B1134 |
| | | 904.1 | | 904.2000.03385 | 1 | KIT, O-RING | | | | | | BUNA | |
| | | 104.1 | | 104.5600.03391 | 1 | O-RING | 12 x 1.5 | | | | | BUNA | |
| | | 104.2 | | 104.5600.03393 | 1 | O-RING | 40 x 1.5 | | | | | BUNA | |



| | |
|-----------------------------|---------|
| WET END PARTS - BOM | |
| HDS 100L-0 (OPEN SUCTION) | |
| DRAWING NBR.: A1186 | REV.: 1 |
| EFFECTIVE DATE : 5 FEB 2013 | |