

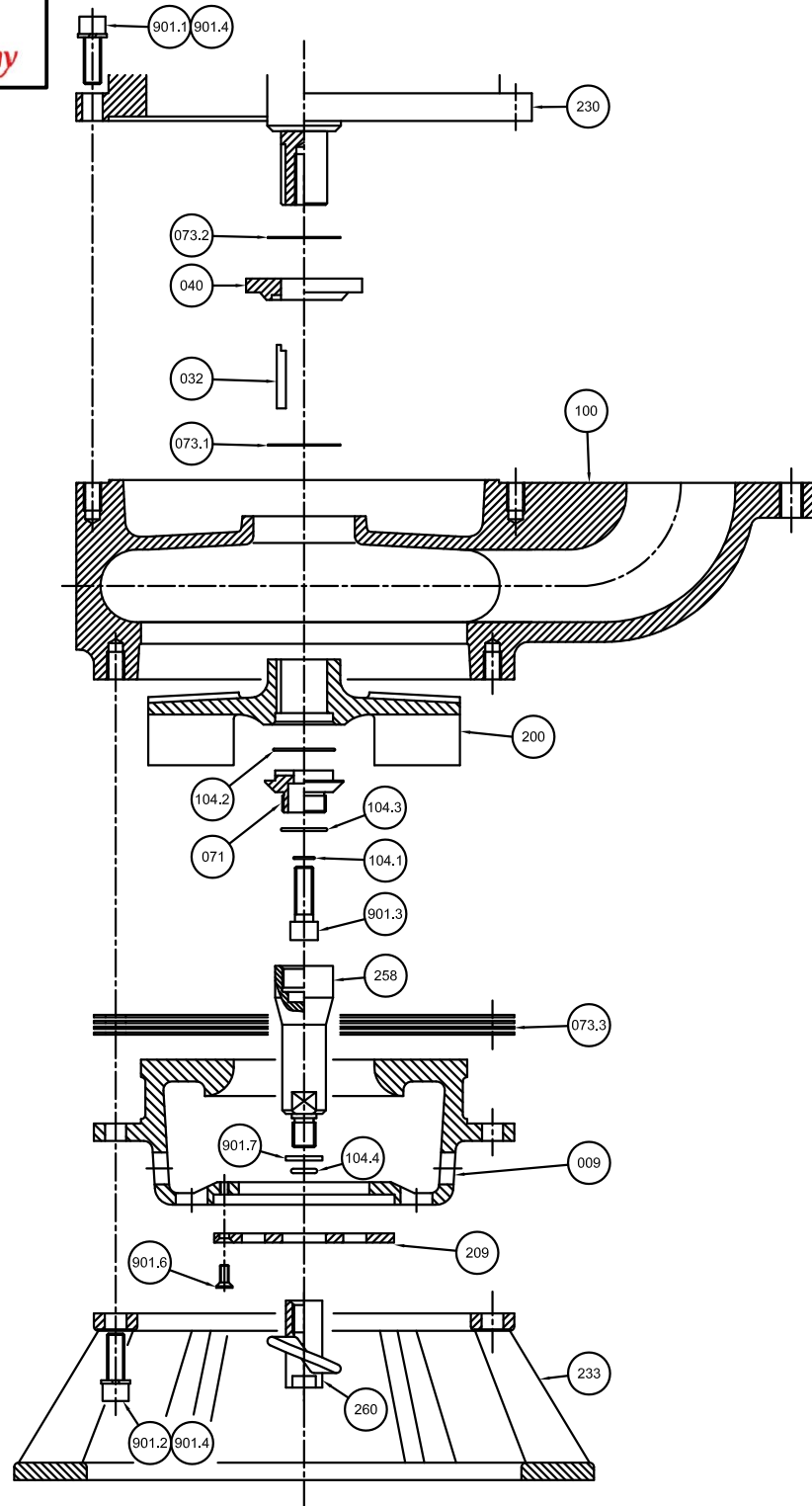

VULCAN PUMPS - HDS 100M-A (HIGH CHROME WET END / MEDIUM PRESSURE HYDRAULIC / 4 INCH DISCHARGE / AGITATOR)

ITEM	ITEM	ITEM	ITEM	PART NUMBER	QTY.	DESCRIPTION	EXT. DESC.1	MODEL1	MODEL 2	WT. (KG)	WT. (lbs)	MTL.	DWG. #
707				707.2000.03665		KIT, WET END - COMPLETE	340mm IMP	HDS 100M	A	154.95	340.86	HIGH CHROME	
	701			701.2000.03516	1	KIT, WET END - BASIC	340mm IMP	HDS 100M		152.32	335.06	HIGH CHROME	
		100		100.1228.03015	1	CASING	VOLUTE	HDS 100M				A532 CL III TP. A	D1021
		200		200.1228.03045	1	IMPELLER	RH, 4V, 340mm VTD	HDS 100M				A532 CL III TP. A	C1051
		009		009.1228.03097	1	COVER	SUCTION	HDS 100M				A532 CL III TP. A	D1074
		040		040.2229.03213	1	DEFLECTOR	IMPELLER	FRAME 250TY / 320TYS				ASTM A276 TYPE 316	B1108
		233		233.1051.03073	1	STAND	PUMP	HDS 100M				ASTM A536 Gr. 80-55-06	C1400
		032		032.2228.03264	1	KEY	DRIVE	FRAME 250TY / 320TYS				304SS	B1119
		902		902.2000.03338	1	KIT, FASTENER						A4/70	
		901.1		901.2334.03283	8	FASTENER	SCREW	HEX SOCKT.HD.CAP	DIN 912 / M16 X 45			A4/70	
		901.2		901.2334.03334	6	FASTENER	SCREW	HEX SOCKT.HD.CAP	DIN 912 / M16 X 50			A4/70	
		901.3		901.2255.03296	1	FASTENER	SCREW	HEX SOCKT.HD.CAP	ANSI B18.3 / 5/8"UNC X 1.50"			17-4 H 1150	
		901.4		901.2334.03293	14	FASTENER	WASHER	LOCK	DIN 127B / M16			A4/70	
		903.1		903.2000.03343	1	KIT, GASKET		FRAME 250TY / 320TYS					
		073.1		073.5108.03347	1	GASKET	IMPELLER	FRAME 250TY / 320TYS				Durlon 8500	B1122
		073.2		073.5108.03348	1	GASKET	DEFLECTOR	FRAME 250TY / 320TYS				Durlon 8500	B1125
		903.2		903.2000.03356	1	KIT, GASKET		HDS 100M					
		073.3		073.5108.03363	4	GASKET	SUCTION	HDS 100M				Durlon 8500	B1131
		905		905.2000.03121	1	KIT, AGITATOR		HDS 100M	A	0.85	1.88		
		260		260.1228.03127	1	AGITATOR	ROTATING	HDS 100M	A			A532 CL III TP. A	B1086
		209		209.2338.03155	1	SCREEN	SUCTION	HDS 100M				QT400	B1096
		901.6		901.2334.03298	3	FASTENER	SCREW	HEX SOCKT, CSK. HD. FLAT	DIN 7991 / M6 X 12			A4/70	
		906		906.2000.03318	1	KIT, SHAFT EXTENSION		HDS 100M	A	1.78	3.92		
		071		071.2259.03187	1	ADAPTER	SHAFT	FRAME 250TY / 320TYS	A			ASTM A564 Gr.630 (17-4 PH)	B1105
		258		258.2259.03328	1	EXTENSION	SHAFT	HDS 100M	A			ASTM A564 Gr.630 (17-4 PH)	B1155
		904.1		904.2000.03386	1	KIT, O-RING						BUNA	
		104.1		104.5600.03392	1	O-RING	16 x 1.5					BUNA	
		104.2		104.5600.03394	1	O-RING	58 x 1.5					BUNA	
		904.2		904.2000.03389	1	KIT, O-RING						BUNA	
		104.3		104.5600.03398	1	O-RING	32 x 3					BUNA	
		104.4		104.5600.03397	1	O-RING	12 x 3					BUNA	
		901.7		901.2334.03306	1	FASTENER	WASHER	CUSTOM	M16			A4/70	



WET END PARTS - BOM	
HDS 100M-A (AGITATOR)	
DRAWING NBR.: A1211	REV.: 1
EFFECTIVE DATE : 5 FEB 2013	